

STR7™ Low Profile LED Strip Luminaire





The STR7™ is a low profile strip luminaire designed for installations where performance is essential and space is limited.

Typical Applications include showcase and under-cabinet lighting, cove, effect lighting, task and emergency lighting and delineation.

STR7™ is available in 6 color temperatures of white as well as Amber, Red, Green and Blue.

This Luminaire is particularly suited to installation in tight spaces where other fixtures simply will not fit. With external dimensions of only 45mm wide and 18mm high the STR7™ can be installed in the smallest of spaces.

Mounting onto almost any surface is easily achieved with number 4 screws through the integral mounting flange. It is strongly recommended that the luminaire be mounted onto a metal or concrete surface in order to sufficiently dissipate heat and ensure that the LEDs last their full rated lifetime.

Features

- Interior application very low profile surface mounted strip light with high power LED light source
- Anodized aluminum body available in two standard finishes
- Easy to install with #4 screws through the mounting flange
- Designed to accommodate a variety of GVA's LED Light Engines with high power LEDs
- Power/Data cable - 300mm standard length
- Cool beam, no heat (IR) or UV generated from light source
- Input voltage 24VDC
- Must be installed on metal or concrete surface for proper thermal management (Discuss your application with GVA Lighting)
- 5 Year Limited Warranty

Options

- Nominal lengths of 300mm, 600mm, 900mm, 1200mm, 1500mm, 1800mm, 2100mm and 2400mm.
- Clear Matte or Black Matte anodized body
- Clear or Opal lens.
- 3 x 1W LEDs or 6 x 1W LEDs per 300mm/1ft. segment
- 6 color temperatures of White diodes, plus Red, Amber, Green and Blue
- High CRI available for all colour temperatures of White LEDs
- On/Off or dimmable through DMX control. Compatible with GVA Lighting or third party DMX512-A control systems
- Analog or push dimming available with MD3 adapter



Specification Logic

FAMILY	NOMINAL LENGTH	BODY COLOR	LENS COLOR	LED QTY. PER 300MM/1FT.	LED POWER	BEAM ANGLE	LED COLOR	CRI**	INPUT SIDE	OPTIONS
STR7	300	CM - Clear Matte	CLR - Clear	3	1W	120°	2700K	H3 - Standard	LH - Left hand feed	ND - No Dimming, On/Off
	600	BM - Black Matte	OPL - Opal	6			3000K			
	900						3500K			LL - Specify custom lead cable length in mm if not standard (ex. LL450, max. 300 for DMX)
	1200						4000K			
	1500						5000K			
	1800						6500K			
	2100						AM- Amber			
	2400						RD - Red			
							GR - Green			
							BL - Blue			

Sample Logic : STR7-600-CM-CLR-6-1W-120°-5000K-H3-LH-ND

Product Specifications											
Nominal Length		300	600	900	1200	1500	1800	2100	2400		
Electrical	Rated Input Voltage	24VDC									
	Power Consumption DC Side (typical, LEDs driven @ 300mA)	3 x 1W LEDs 6 x 1W LEDs	3.6W 7.2W	7.2W 14.5W	10.9W 21.7W	14.5W 29W	18.1W 36.3W	21.8W 43.5W	25.4W 50.8W	29W 58.1W	
	Approved Remote AC/DC Power Supplies	Use only with listed Class 2 power supply unit, 24VDC									
	Maximum run length for end-to-end connection* (to maintain class 2 circuit)	3 x 1W LEDs 6 x 1W LEDs	8.1m, 27ft 3.9m, 13ft								
	Optical	Light Source	3 x 1W or 6 x 1W Nichia 183 series or Cree MX series LEDs								
	CRI** (For White 183 Series LEDs)	Standard CRI (H3): Min 75, Typ 85; High CRI (H1): Min 85, Typ 92									
	Lumens (typical for Standard CRI, 3500K LEDs @ 300mA @ 25°C ambient)***	6 x 1W LEDs	400	800	1200	1600	2000	2400	2800	3200	
		2700K								0.89	
		3000K								0.93	
	Lumens de-rating coefficient depends on color temperature***	3500K								1.00	
		4000K								1.00	
		5000K								1.05	
		6500K								1.05	
	Lumens de-rating coefficient depends on CRI	High CRI (H1)								0.85	
	Beam Angle (FWHM)	120°									
	Projected Lumen Maintenance****	50,000 hours @ 30°C (B50, L70)									
Control	Interface Options	On/Off (No Dimming) DMX512-A compatible (when applicable) Analog (0-10VDC) through Analog-To-DMX MD3-AD adapter Push-Dim through PD-to-DMX MD3-DMX adapter									
	Control Systems	Pharos or any third party DMX512-A controllers GVA's Push-Dimmer Third party analog (0-10VDC) controller									
	Physical	Width x Height	mm inches	46.5 x 17 1.83 x 0.67							
	Actual Length	mm inches	328 12.9	622 24.48	915 36.02	1207 47.52	1501 59.1	1793 70.6	2085 82.1	2378 93.6	
	Weight	kg lbs	0.15 0.33	0.3 0.66	0.45 0.99	0.6 1.32	0.75 1.65	0.9 1.98	1.05 2.31	1.20 2.64	
	Housing	Extruded aluminum body, ABS endcaps, Provista Copolymer or Acrylic lens									
	Fixture Connections	0.6m/2ft lead cable with stripped wires									
	Rated Operating Temperature****	-10°C to +30°C, 14°F to 86°F									
	Environment	Dry Locations, 0-80% humidity, non condensing									
Certification & Safety	Listings	cULus, CE, RoHS									
	UL Classification	Low Voltage LED Class 2 Luminaire									
	IEC Classification	Surface Mount, Indoor-Use, Class III, IP40, for normal use									
	LED Class	Class 2 LED product									



IP40



* Values for standard drive current. Longer runs achievable with under-driven LEDs. Nominal length shown; actual length = actual fixture lengths + fixture spacings

** CRI only applicable to White LEDs

*** These figures are subject to change due to further development and innovations of LED light sources.

**** Luminaire must be mounted on metal or concrete surface for proper thermal management

Mechanical Drawing

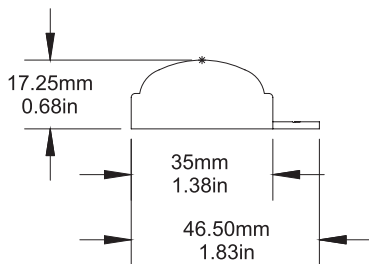
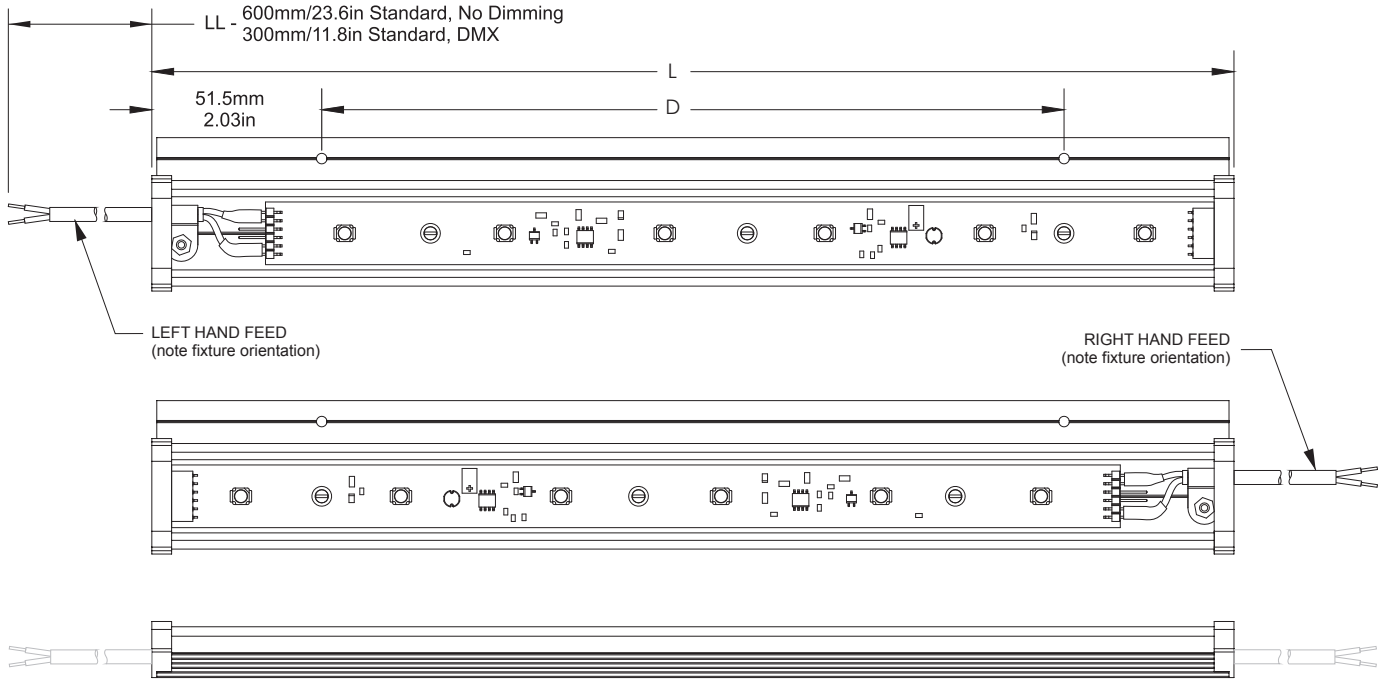

Nominal	L		D	
	mm	in	mm	in
300	328	12.9	225	8.86
600	621	24.4	259.5	10.22
900	915	36.0	270.7	10.66
1200	1207	47.5	276	10.87
1500	1501	59.1	279.6	11.01
1800	1793	70.6	281.7	11.09
2100	2085	82.1	283.1	11.15
2400	2378	93.6	284.4	11.20

Application Examples



CREATING NEW BEAUTY FOR OUR HOME PLANET™



L I G H T I N G *GVA*

GVA Lighting, Inc.
3400 Ridgeway Drive, # 14
Mississauga, Ontario L5L 0A2, Canada
Phone: + 1 905 569 6044
Toll Free Phone (Canada and USA):
1 877 GVA LIGHT or 1 877 482 5448
Fax: + 1 905 569 9823
Email: info@gvalighting.com

gvalighting.com